

# Product data sheet

Specifications



## Fixing plate with 800mm aluminium pole for modular tower lights, Harmony XVU, black, 60mm

XVUZ800

⚠ To be discontinued on: May 31, 2026

⚠ To be discontinued

### Main

|                                    |                               |
|------------------------------------|-------------------------------|
| Range of product                   | Harmony XVU                   |
| Product or component type          | Modular tower light           |
| Accessory / separate part type     | Fixing plate                  |
| Accessory / separate part category | Mounting and fixing accessory |
| Component name                     | XVU                           |
| Mounting diameter                  | 60 mm                         |

### Complementary

|                           |  |
|---------------------------|--|
| Pole height               | 800 mm   |
| Mounting support          | Plate with pole  |
| Product compatibility     | Top: AC/DC body  |
| Material                  | PBT (polybutylene terephthalate) V-0 conforming to UL 94<br>ABS (acrylonitrile butadiene-styrene)<br>PC (polycarbonate)<br>Aluminium |
| Housing colour            | Black  |
| Connections - terminals   | Push-in  |
| [Us] rated supply voltage | 24 V AC/DC<br>110...240 V AC   |
| Length                    | 817 mm   |
| Product weight            | 0.43 kg  |

### Environment

|                                       |                 |
|---------------------------------------|-----------------|
| Ambient air temperature for storage   | -40...70 °C     |
| Ambient air temperature for operation | -25...50 °C     |
| IP degree of protection               | IP65            |
| Product certifications                | UL<br>CSA<br>CE |

### Packing Units

|                              |     |
|------------------------------|-----|
| Unit Type of Package 1       | PCE |
| Number of Units in Package 1 | 1   |

|                                     |            |
|-------------------------------------|------------|
| <b>Package 1 Height</b>             | 9.000 cm   |
| <b>Package 1 Width</b>              | 9.500 cm   |
| <b>Package 1 Length</b>             | 96.500 cm  |
| <b>Package 1 Weight</b>             | 909.000 g  |
| <b>Unit Type of Package 2</b>       | CAR        |
| <b>Number of Units in Package 2</b> | 6          |
| <b>Package 2 Height</b>             | 21.000 cm  |
| <b>Package 2 Width</b>              | 36.000 cm  |
| <b>Package 2 Length</b>             | 98.500 cm  |
| <b>Package 2 Weight</b>             | 6.360 kg   |
| <b>Unit Type of Package 3</b>       | P12        |
| <b>Number of Units in Package 3</b> | 12         |
| <b>Package 3 Height</b>             | 75.000 cm  |
| <b>Package 3 Width</b>              | 80.000 cm  |
| <b>Package 3 Length</b>             | 120.000 cm |
| <b>Package 3 Weight</b>             | 25.000 kg  |



## Environmental Data

Schneider Electric aims to achieve Net Zero status by 2050 through supply chain partnerships, lower impact materials, and circularity via our ongoing “Use Better, Use Longer, Use Again” campaign to extend product lifetimes and recyclability.

[Environmental Data explained >](#)

[How we assess product sustainability >](#)

### Environmental footprint

Total lifecycle Carbon footprint 4

Environmental Disclosure [Product Environmental Profile](#)

## Use Better

### Materials and Substances

Packaging made with recycled cardboard Yes

Packaging without single use plastic Yes

[EU RoHS Directive](#) Compliant with Exemptions

SCIP Number C06fce4f-aea2-46a5-aadb-0b38d1efbe3f

## Use Again

### Repack and remanufacture

End of life manual availability [End of Life Information](#)

Take-back No

WEEE Label  The product must be disposed on European Union markets following specific waste collection and never end up in rubbish bins

Dimensions Drawings

Fixing Unit - Plate with Pole

---

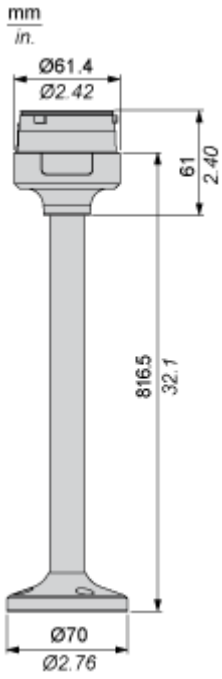

Mounting and Clearance

Modular Tower Lights Mounting

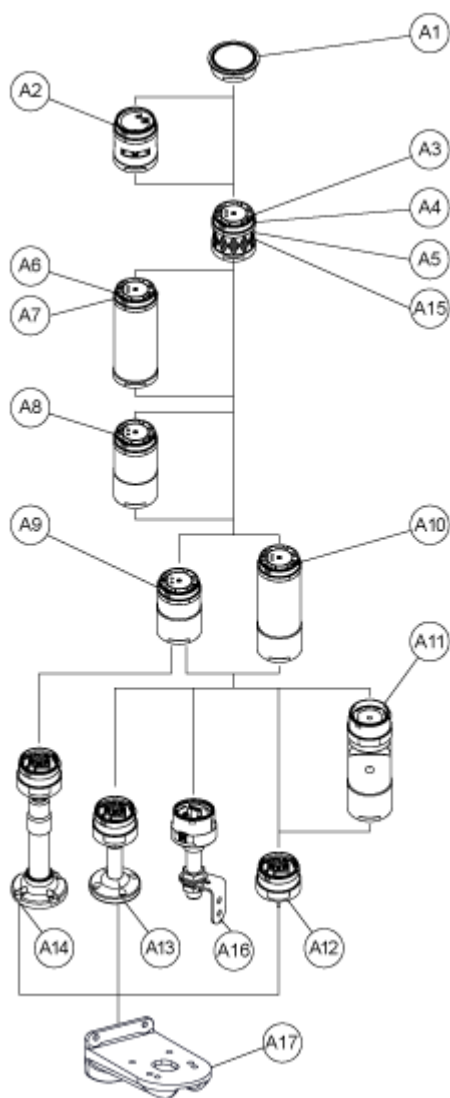

| Drawing | Part number | Part name            |
|---------|-------------|----------------------|
| A1      | -           | Top cover            |
|         | -           | Top cover (Silver)   |
| A2      | XVUC9S      | Buzzer unit          |
|         | XVUC9SQ     | Buzzer unit (Silver) |
| A3      | XVUC23      | Green LED unit       |
|         | XVUC24      | Red LED unit         |
|         | XVUC25      | Orange LED unit      |
|         | XVUC26      | Blue LED unit        |

| Drawing | Part number | Part name   |
|---------|-------------|---|
|         | XVUC27      | White LED unit  |
|         | XVUC28      | Yellow LED unit                                       |
| A4      | XVUC29      | Multi-LED unit  |
| A5      | XVUC29P     | Multi-LED unit, Pulse signal                          |
| A6      | XVUC9V      | Sound unit  |
| A7      | XVUC9VP     | Sound unit, Pulse signal                              |
| A8      | XVUC020     | Extender  |
|         | XVUC020Q    | Extender (Silver)                                     |
| A9      | XVUC21B     | DC body   |
|         | XVUC21BQ    | DC body (Silver)                                      |
| A10     | XVUC21M     | AC body NPN   |
|         | XVUC21MP    | AC body PNP   |
|         | XVUC21MQP   | AC body PNP (Silver)                                  |
| A11     | XVUZ06      | Flexible option                                       |
| A12     | XVUZ01      | Fixing Unit - Direct mounting (3 pins)                |
|         | XVUZ01Q     | Fixing Unit - Direct mounting (Silver,3 pins)         |
|         | XVUZ03      | Fixing Unit - Direct mounting (2 pins)                |
|         | XVUZ04      | Fixing Unit - Direct mounting (4 pins)                |
| A13     | XVUZ02      | Fixing Unit - Plate with Pole (100 mm)                |
|         | XVUZ02Q     | Fixing Unit - Plate with Pole (100 mm, Silver)        |
|         | XVUZ400     | Fixing Unit - Plate with Pole (400 mm)                |
|         | XVUZ800     | Fixing Unit - Plate with Pole (800 mm)                |
| A14     | XVUZ05      | Fixing Unit - Plate with adjustment pole (100-385 mm) |
| A15     | XVUC43      | Green LED unit, Flash                                 |
|         | XVUC44      | Red LED unit, Flash                                   |
|         | XVUC45      | Orange LED unit, Flash                                |
|         | XVUC46      | Blue LED unit, Flash                                  |

| Drawing    | Part number | Part name  |
|------------|-------------|--|
|            | XVUC47      | White LED unit, Flash                            |
|            | XVUC48      | Yellow LED unit, Flash                           |
| <b>A16</b> | XVUZ100T    | Fixing Unit - Metal bracket with pole (100 mm)   |
|            | XVUZ250T    | Fixing Unit - Metal bracket with pole(250 mm)    |
|            | XVUZ400T    | Fixing Unit - Metal bracket with pole (400 mm)   |
| <b>A17</b> | XVUZ12      | Fixing plate for use on vertical support - black |

**Modular Tower Lights Mounting**

---

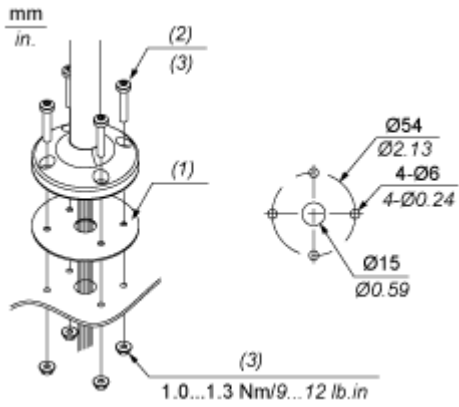

- (1) Gasket
- (2) Screw x 4 (unattached)
- (3) M5 x (thickness+10 mm /0.39 in.)



Connections and Schema

Illuminated Units, Multi-LED and Audible Units Wiring

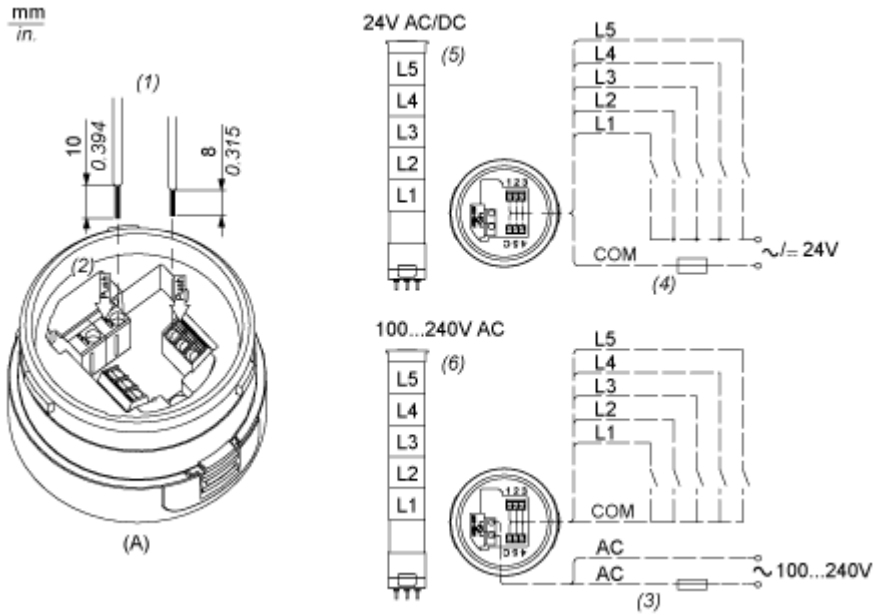

- (A) Fixing Unit
  - (1) Dimensions of Wiring size
  - (2) Push-in Wire Connectors
  - (3) Fuse : 2A ,250V
  - (4) Fuse : 0.5A ,125V
  - (5) Modular Tower Lights 24V AC/DC
  - (6) Modular Tower Lights 100...240V AC
- L1 to L5 : Illuminated LED Units

Technical Illustration

Dimensions

---

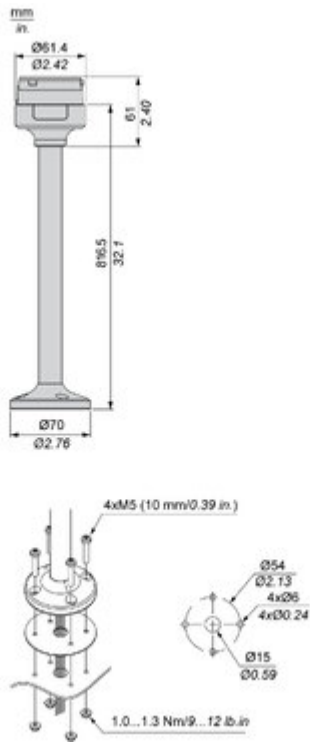

Technical Illustration

Wiring diagram

---

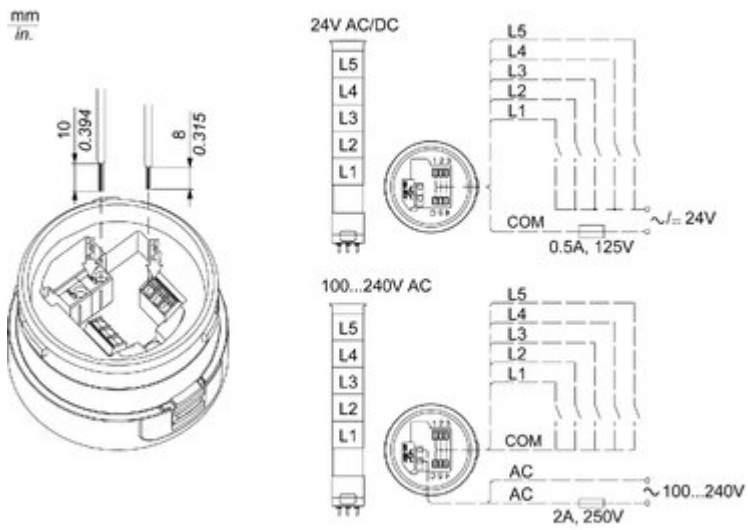

Offer Marketing Illustration

Product benefits / Features

### 功能特点

#### Harmony XVU 模块式信号灯柱



**单色 LED 发光单元:6 色可选;**  
**多色 LED 发光单元:旋钮手**  
**调或者 PLC 信号控制,可发**  
**出多种颜色光,多种闪烁模式**

**模块化结构 客户自行组装,**  
**可组合最多 5 个发光单元**  
**或 4 个发光 +1 个发声单元**

**水平安装:使用直接安装底座、**  
**支撑杆安装底座或可伸缩支撑**  
**杆安装底座固定到安装面板上;**  
**竖直安装:使用带 L 支架支撑杆**  
**安装底座或添加墙装支架固定**  
**到竖直安装面板上**

**安装简化,维护方便,**  
**可直接连接 PLC**

**使用免费的语音编辑软件在电脑上定**  
**制语音,再通过 SD 卡复制到设备中,**  
**多个通道可输出。**

Image of product / Alternate images

Alternative

---





Image of product in real life situation

